

PART NO.	A99421-015	REV	ECO	DATE	APP
		C	102019	11-04-15	TLM

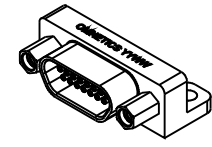
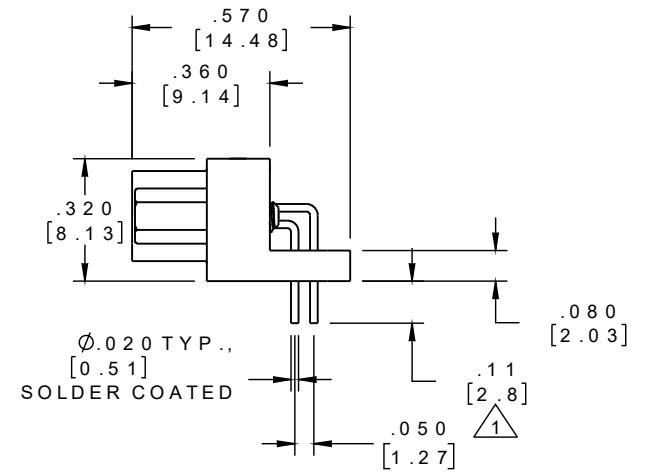
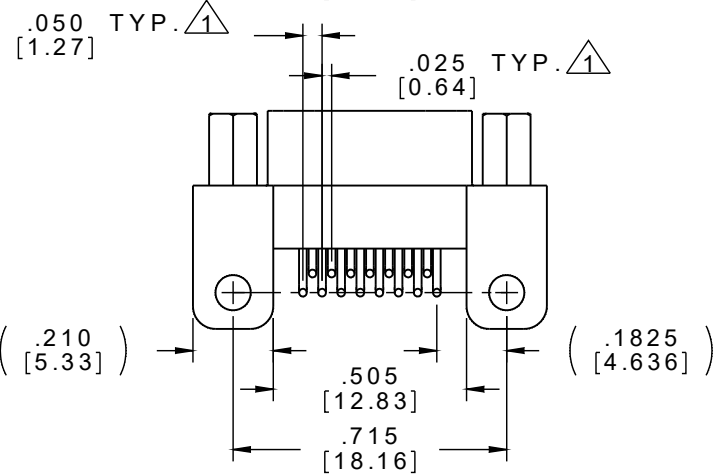
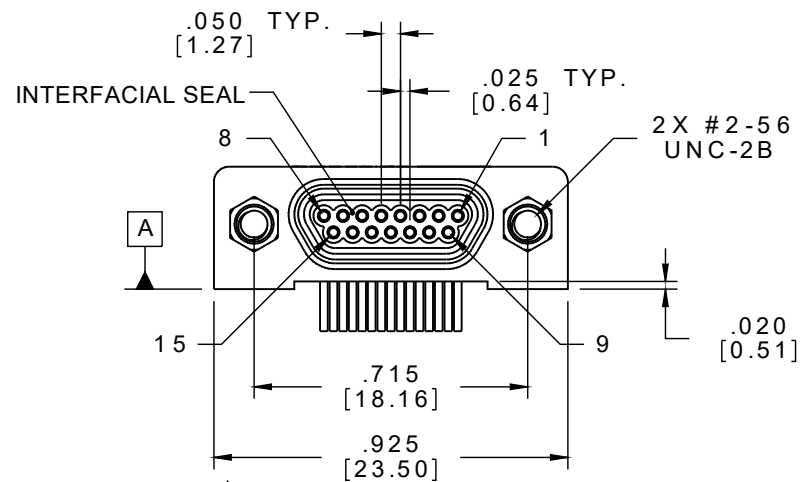
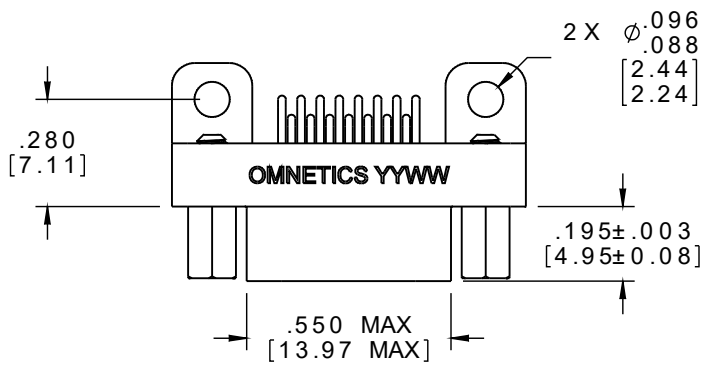

ACTUAL SIZE

NOTE:  
DIMENSIONS IN [ ] ARE IN MILLIMETERS UNLESS OTHERWISE NOTED AND ARE FOR REFERENCE ONLY

△ TAIL DIMENSIONS APPLY AT PLANE A

MMSD/SIDW	THIRD ANGLE	THIS DRAWING CONTAINS CONFIDENTIAL AND PROPRIETARY INFORMATION WHICH IS THE PROPERTY OF OMNETICS CONNECTOR CORP. THIS DOCUMENT MAY NOT, IN WHOLE OR IN PART, BE DUPLICATED, OR DISCLOSED FOR ANY PURPOSE, WITHOUT WRITTEN PERMISSION FROM OMNETICS CONNECTOR CORP.		<b>OMNETICS</b>	CAGE CODE 61873	
	-TOLERANCES- UNLESS OTHERWISE NOTED	DATE	TITLE:		DWG NO.	REV
	DIMENSIONS IN INCHES	DFTM. NJS	01-27-10	(15) SOCKET FEMALE 90° BOARD MOUNT MICRO-D CONNECTOR	A99421-015	SHEET 1 OF 2
	2 PL DEC±.01 3 PL DEC±.005 4 PL DEC±.0005 ANGLES ± 1°	CHK'D.	DATE	7260 COMMERCE CIRCLE EAST MINNEAPOLIS, MN 55432 WWW.OMNETICS.COM	SCALE: 2:1	C
	APP'D.	DATE				

PART NO.	A99421-015	REV	ECO	DATE	APP
		C	102019	11-04-15	TLM

**MATERIALS**

**HOUSING:**

ALUMINUM 6061-T6, NICKEL  
PLATE PER SAE-AMS-2404

**INSULATOR:**

LIQUID CRYSTAL POLYMER (LCP)  
PER ASTM D5138

**CONTACT:**

COPPER ALLOY PER MIL-DTL-  
83513, GOLD PLATED PER  
ASTM B488, (HARD GOLD) TYPE  
II CODE C CLASS 1.27

**TERMINATION:**

SOLDER COATED WITH SN63A  
PER J-STD-006 OR AMS-P-  
81728

**INTERFACIAL SEAL:**

SILICONE RUBBER PER A-A-  
59588

**HARDWARE:**

STAINLESS STEEL, PASSIVATED  
PER SAE-AMS-2700

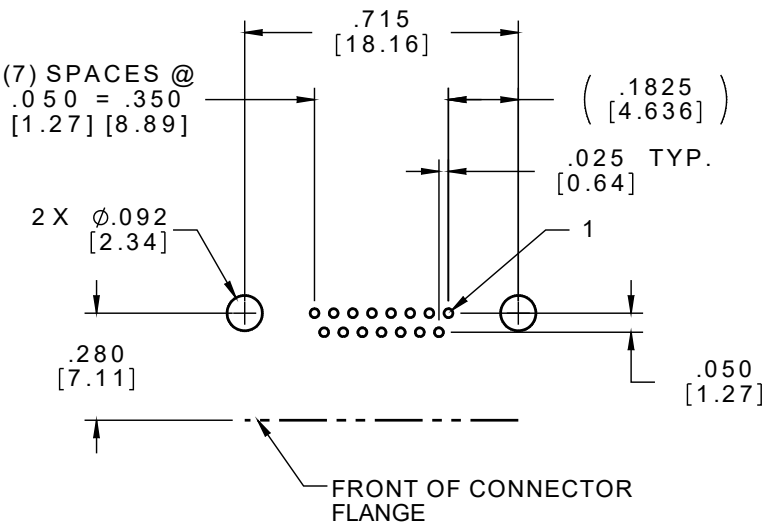

SUGGESTED HOLE PATTERN

FRONT OF CONNECTOR  
FLANGE

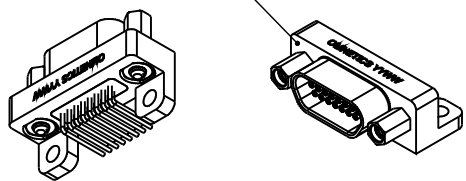

ACTUAL SIZE

**NOTE:**

DIMENSIONS IN [ ] ARE IN  
MILLIMETERS UNLESS  
OTHERWISE NOTED AND ARE  
FOR REFERENCE ONLY

MINDS S/DW S/DW	THIRD ANGLE	THIS DRAWING CONTAINS CONFIDENTIAL AND PROPRIETARY INFORMATION WHICH IS THE PROPERTY OF OMNETICS CONNECTOR CORP. THIS DOCUMENT MAY NOT, IN WHOLE OR IN PART, BE DUPLICATED, OR DISCLOSED FOR ANY PURPOSE, WITHOUT WRITTEN PERMISSION FROM OMNETICS CONNECTOR CORP.		<b>OMNETICS</b>	CAGE CODE 61873	
	-TOLERANCES- UNLESS OTHERWISE NOTED DIMENSIONS IN INCHES	DFTM. NJS	DATE 01-27-10		TITLE:	CONNECTOR CORPORATION
	2 PL DEC ± .01	CHK'D.	DATE	(15) SOCKET FEMALE	7260 COMMERCE CIRCLE EAST	SHEET 2 OF 2
	3 PL DEC ± .005	APP'D.	DATE	90° BOARD MOUNT	MINNEAPOLIS, MN 55432	REV C
4 PL DEC ± .0005			MICRO-D CONNECTOR	WWW.OMNETICS.COM	SCALE: 2:1	
ANGLES ± 1°						